

RETAINING BLOCKS

Terraforce & Terravert

Brochure



EASTERN CAPE SUPPLIERS
OF TOP QUALITY PRECAST
CONCRETE PRODUCTS

TERRAFORCE

S10 (500) HEAVY DUTY APPLICATIONS

SPECIFICATIONS

3D Image

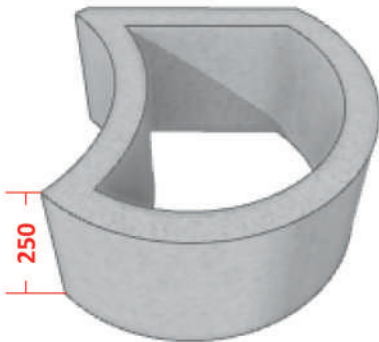

Top View

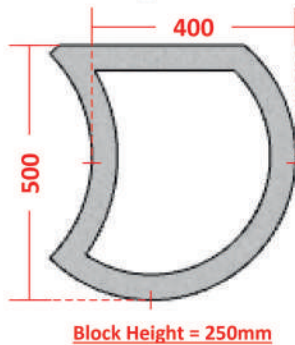

- Wall width 500mm
- 10 blocks per square meter
- Unit mass 45kg
- Wall mass 850kg per square meter
- Block infill volume 24 liters
- Cast in 35MPA concrete mix design
- Variable setback and wall angles permitted

Ideal for large-scale and challenging retaining walls, for walls up to 9 meters high and built 500mm wide. Used for heavy-duty landscaping and erosion control suiting both straight and curved structures.

L11 (350) MEDIUM DUTY APPLICATIONS

SPECIFICATIONS

3D Image

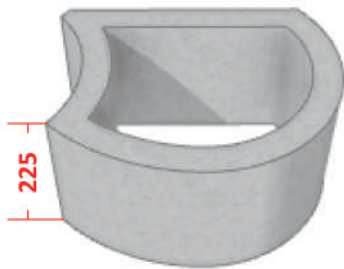

Top View

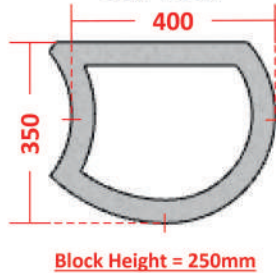

- Wall width 350mm
- 11 blocks per square meter
- Unit mass 31kg
- Wall mass 566kg per square meter
- Block infill volume 15 liters

Ideal for large-scale and challenging retaining walls, for walls up to 9 meters high and built 500mm wide. Used for heavy-duty landscaping and erosion control suiting both straight and curved structures.

3D EXAMPLE

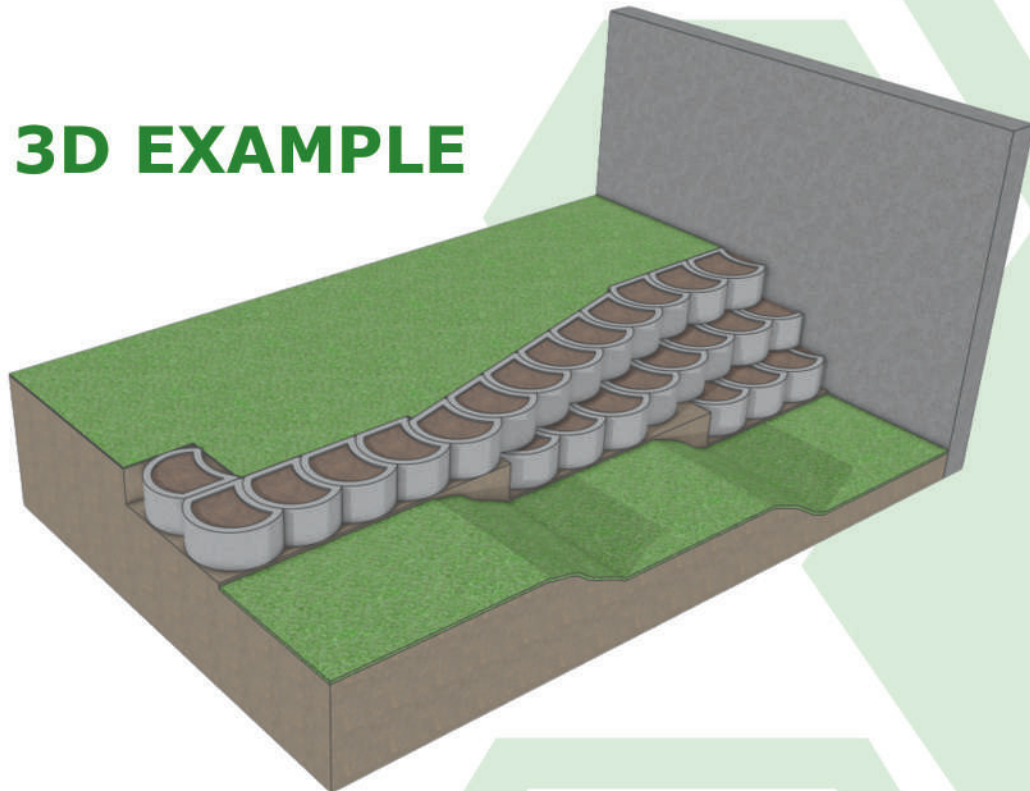

Important Note: To ensure an accurate and efficient quote, please provide all essential details when making a request. Kindly include your name, contact number, email address, and a plan of the area. This helps us assist you promptly and provide the best possible service.

TERRAVERT

V10 (250)

SPECIFICATIONS

3D Image

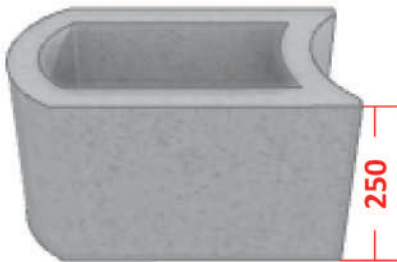

Top View

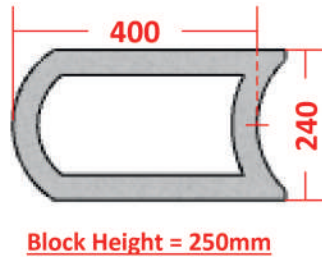

- Wall width 250mm
- 10 blocks per square meter
- Unit mass 25kg
- Wall mass 390kg per square meter
- Block infill volume 11 liters
- Available in a rockface finish

A versatile and cost-effective choice for lighter retaining walls, perfect for D.I.Y. projects and tight spaces. With a narrow 250mm width, they create seamless 90-degree angles and wall terminations while offering long-lasting, corrosion-free durability.

VC10

SPECIFICATIONS

3D Image

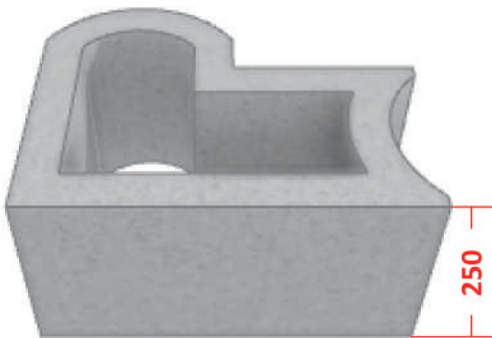

Top View

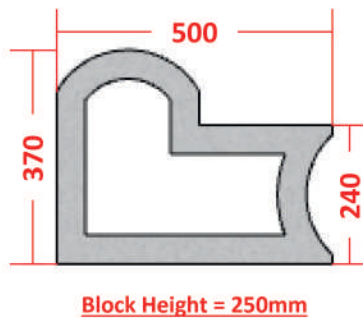

- Wall width 300mm
- 10 blocks per square meter
- Unit mass 25kg
- Wall mass 390kg per square meter
- Block infill volume 11 liters
- Available in a rockface finish

These blocks are complementary to the V10 blocks for using at and around corners.

V8 (400)

SPECIFICATIONS

3D Image

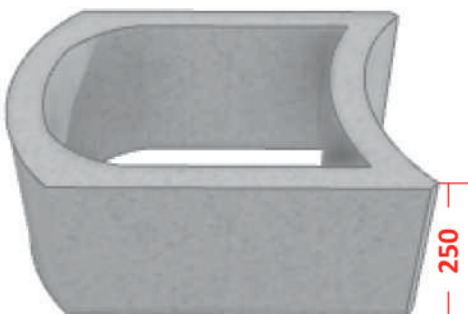

Top View

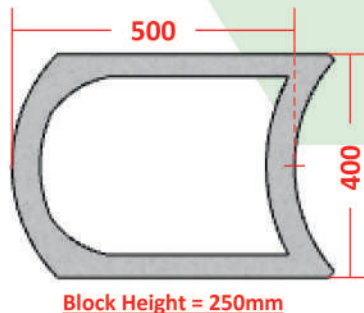

- Wall width 400mm
- 8 blocks per square meter
- Unit mass 50kg
- Wall mass 616kg per square meter
- Block infill volume 23 liters
- Available in a rockface finish

A powerful and cost-effective solution for vertical or near-vertical heavy-duty retaining walls, the V8 Blocks offer strength, durability, and a natural aesthetic. Available in 400mm and 320mm widths, they provide a cost-effective option with smooth or rockface finishes for a polished look.

Please note: All retaining walls built over 1800mm in height need to be engineered

Important Note: To ensure an accurate and efficient quote, please provide all essential details when making a request. Kindly include your name, contact number, email address, and a plan of the area. This helps us assist you promptly and provide the best possible service.

3D Image

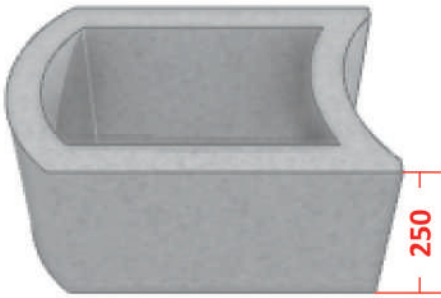

Top View

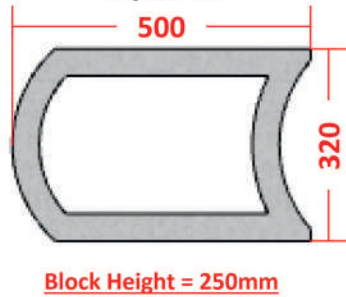

- Wall width 320mm
- 8 blocks per square meter
- Unit Mass 37kg
- Wall mass 564kg per square meter
- Block infill volume 22 liters
- Available in a rockface finish

A powerful and cost-effective solution for vertical or near-vertical heavy-duty retaining walls, the V8 Blocks offer strength, durability, and a natural aesthetic. Available in 400mm and 320mm widths, they provide a cost-effective option with smooth or rockface finishes for a polished look.

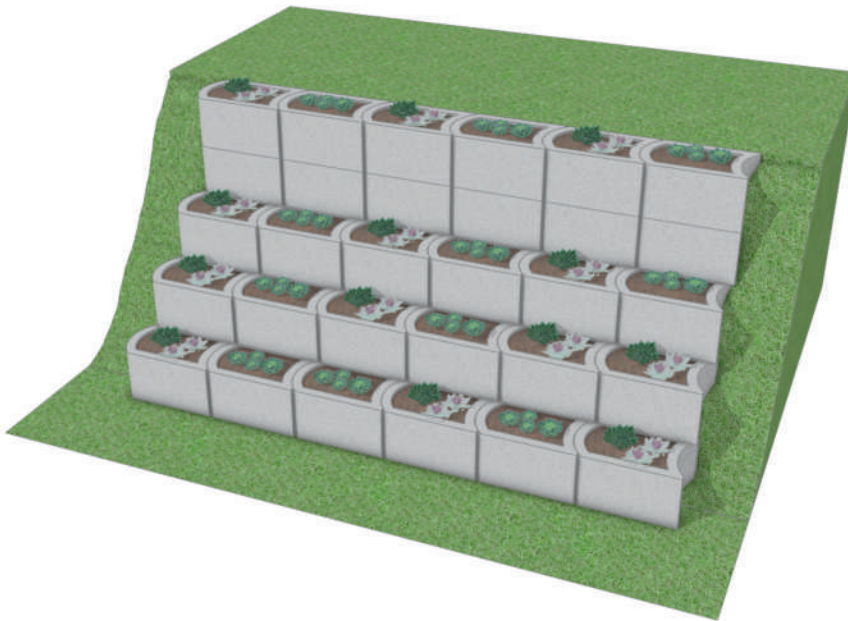

3D EXAMPLE

RETAINING BLOCKS

Reshape your outdoor space with these durable & versatile Retaining Blocks. Our plantable earth retaining wall systems offer the perfect balance of strength, flexibility, and aesthetics for any landscaping or construction project. Whether you're building a heavy-duty retention wall, a decorative garden feature, or a functional stairway, our retaining blocks provide a cost-effective and long-lasting solution. Designed for stability and ease of installation, these blocks support plant growth while preventing erosion, ensuring a beautiful and sustainable outdoor space.

Why Choose Our Retaining Blocks?

- ✓ **Strong & Reliable:** Engineered for medium to heavy-duty applications, providing long-lasting structural support for walls up to 11 meters high.
- ✓ **Easy to Install & Cost-Effective:** Designed for quick assembly with minimal maintenance, reducing overall construction time and expenses.
- ✓ **Versatile & Adaptable:** Suitable for various applications, including garden stairways, planter boxes, and curved or straight walls with adjustable inclinations.
- ✓ **Eco-Friendly & Plant Supportive:** Allows for topsoil infill, promoting plant growth and integrating seamlessly with natural landscapes.

Important Note: To ensure an accurate and efficient quote, please provide all essential details when making a request. Kindly include your name, contact number, email address, and a plan of the area. This helps us assist you promptly and provide the best possible service.

CAST TO LAST

Plantable Earth Retaining Wall Systems for medium to heavy gravity mass retentions. Provided for vertical to 30-degree angle applications including for stairways and planter boxes.



Visit our website
www.tfsd.co.za



A SUPERIOR PRODUCT

Leading manufacturers of top-class concrete products. TFSD is a long established manufacturer of precast concrete products. We supply innovative concrete products that provide for cost effective, everlasting, fast track construction systems, by and for the Eastern Cape built environment. We commit to always being on time, backed up by our on-site technical service and years of practical experience.